



REPUBLIC OF THE PHILIPPINES  
OFFICE OF THE PRESIDENT  
**METROPOLITAN MANILA DEVELOPMENT AUTHORITY**  
(Pangasiwaan Sa Pagpapaunlad Ng KalakhangMaynila)  
**ISO 9001: 2015 CERTIFIED**



***Proposed Landscape Treatment Pocket Park @ EDSA Kamias, Kamuning  
to Timog Ave. underneath Flyover Center Island, Quezon City  
(Package No. 5)***

***BID BULLETIN NO. 1***

November 15, 2021

All prospective bidders are hereby informed of the following amendment/s and/or clarifications for the above stated project;

- A. Schedule of Site Inspection is on November 17, 2021 at 9:00 a.m. meeting place is at EDSA-Tramo.
- B. Section III. Bid Data Sheet ITB Clause 10.4 –Requires the presence of both Project Engineer and Architect to do the structural and architectural works.
- C. Section II-Instructions to Bidders #16 Sealing and Markings of Bid- There are no additional copies, hard or electronic, of the Bid Proposal required.
- D. Section III. Bid Data Sheet ITB Clause 10.4-The list of key personnel to be assigned/dedicated to the project, with their complete qualification and experience as stated in the ITB. When these personnel are assigned to a particular project, they must be available during the project duration such that the project schedule is strictly observed, without delay.
- E. Section III. Bid Data Sheet ITB Clause 10.3- Required PCAB License for the project is under Medium A size range and License Category “B” and above
- F. Section VII. Drawings- See attached document.
- G. Copy of Minutes of Pre-Bid Conference can be acquired at Office of the BAC Secretariat.

This Bid Bulletin shall form an integral part of the bid documents for the project.

  
**USEC FRISCO SAN JUAN JR.**  
BAC Chairman

# PERSPECTIVE VIEWS OF PROPOSED EDSA POCKET PARK FOR THE FIVE (5) PACKAGES

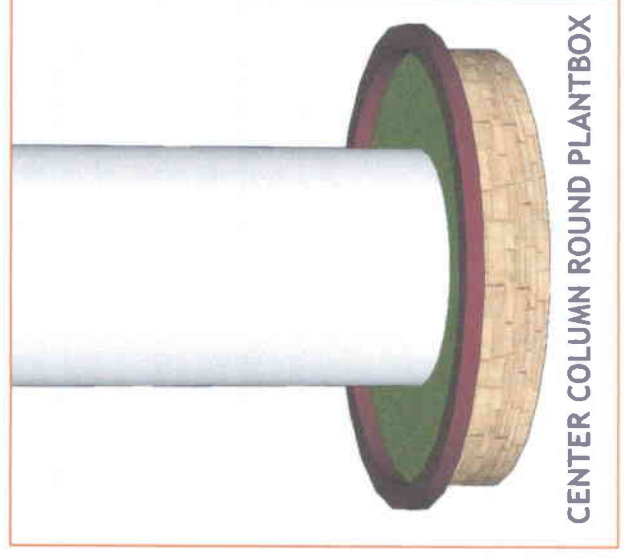
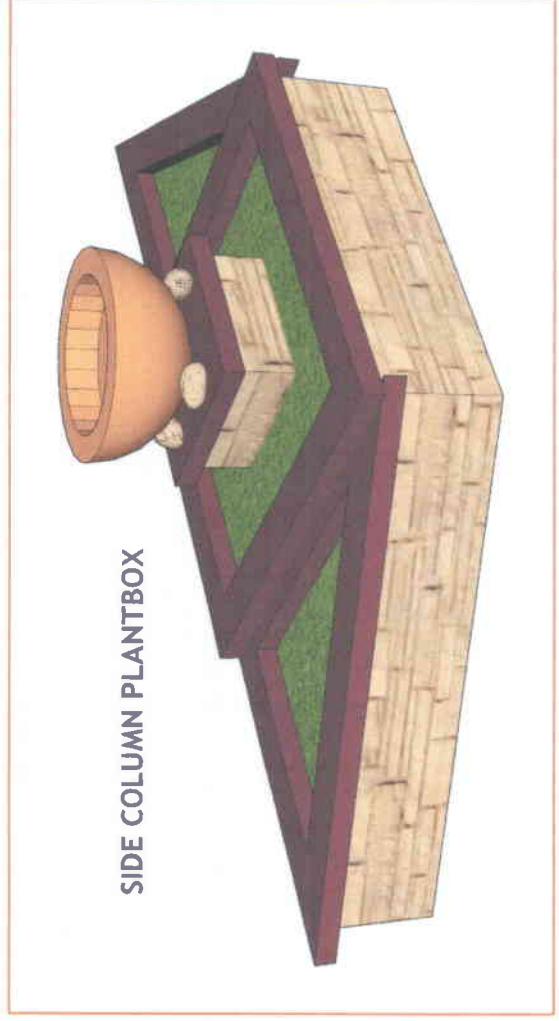

# PERSPECTIVE VIEWS OF PROPOSED EDSA POCKET PARK FOR THE FIVE (5) PACKAGES

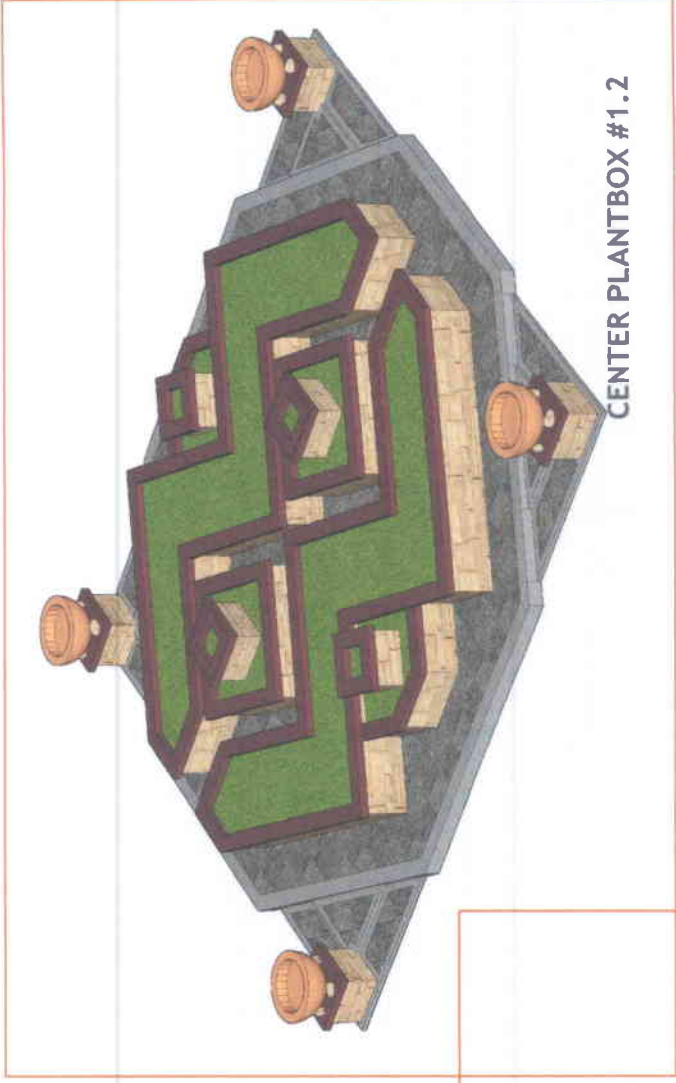

# PERSPECTIVE VIEWS OF PROPOSED EDSA POCKET PARK FOR THE FIVE (5) PACKAGES



CENTER COLUMN PLANTBOX #1



CENTER COLUMN PLANTBOX #2

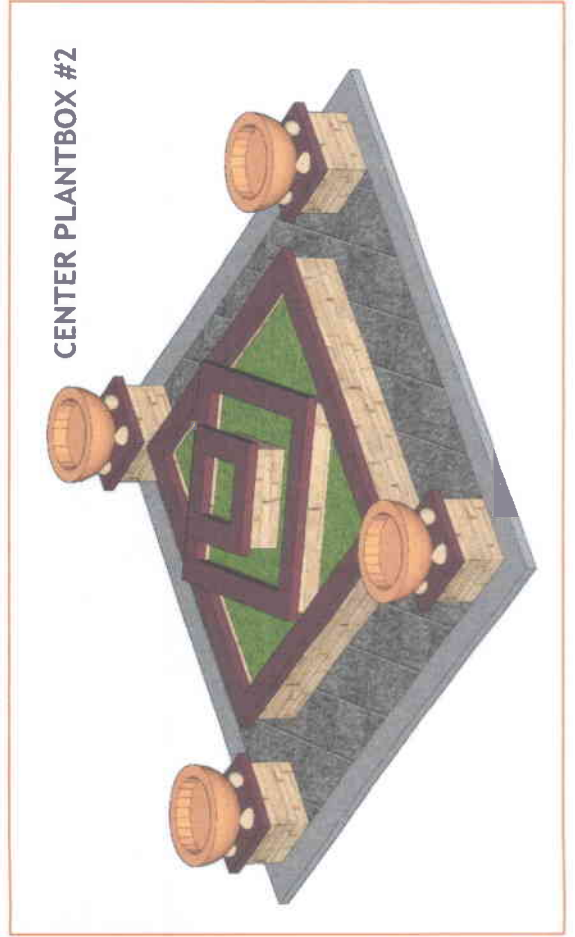

CENTER PLANTBOX #2



CENTER PLANTBOX #3

# DETAILED DIMENSIONS OF PROPOSED EDSA POCKET PARK FOR THE FIVE (5) PACKAGES

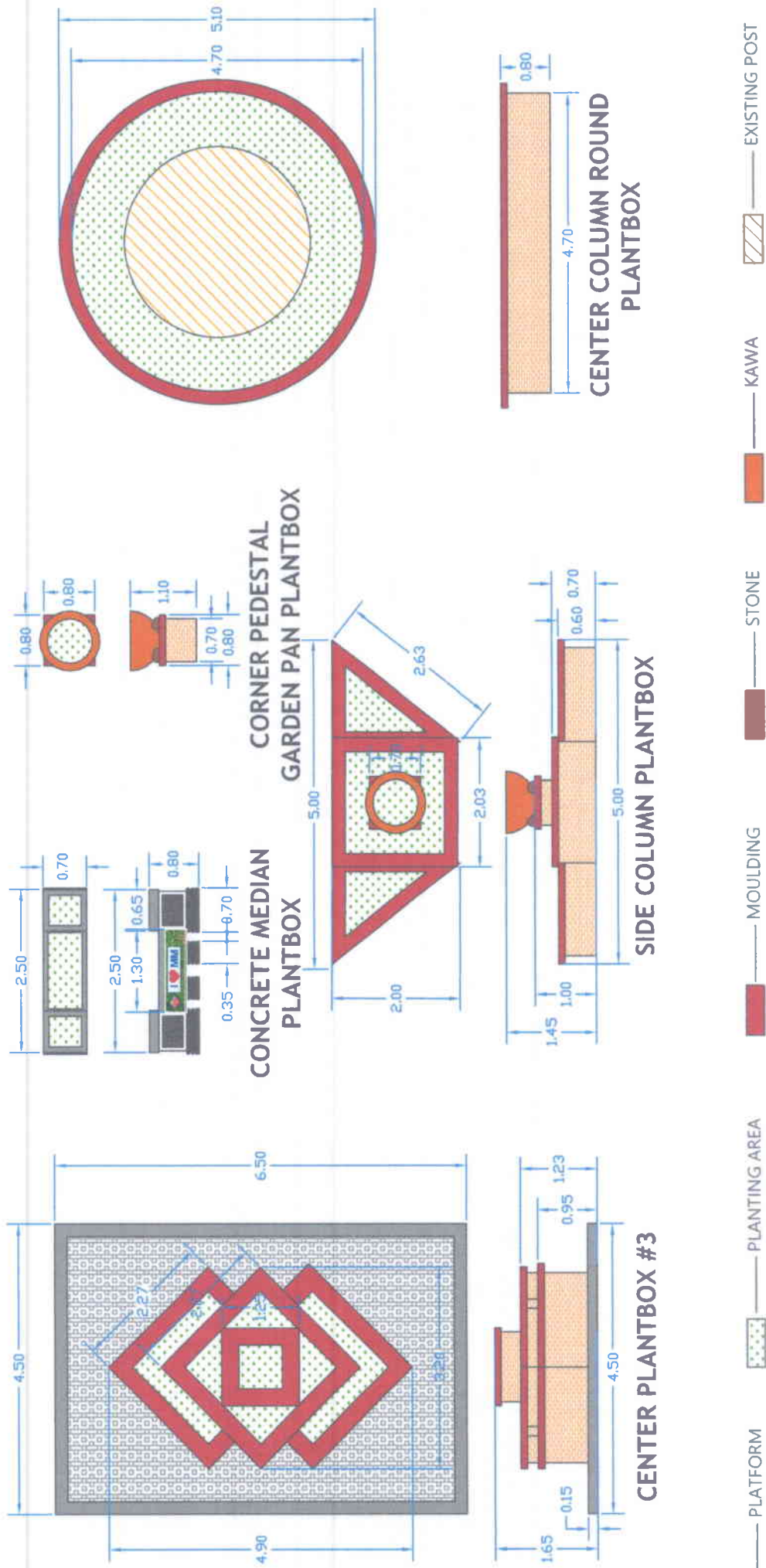

LEGEND:

-  PLATFORM
-  PLANTING AREA
-  MOULDING
-  STONE
-  KAWA
-  EXISTING POST

# DETAILED DIMENSIONS OF PROPOSED EDSA POCKET PARK FOR THE FIVE (5) PACKAGES

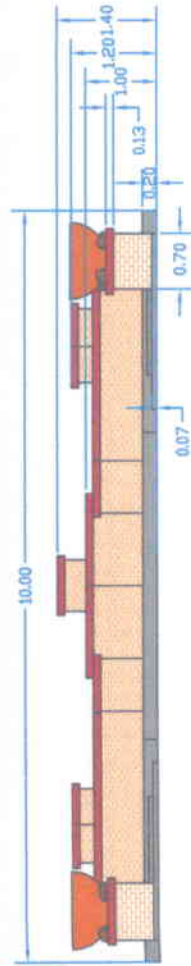
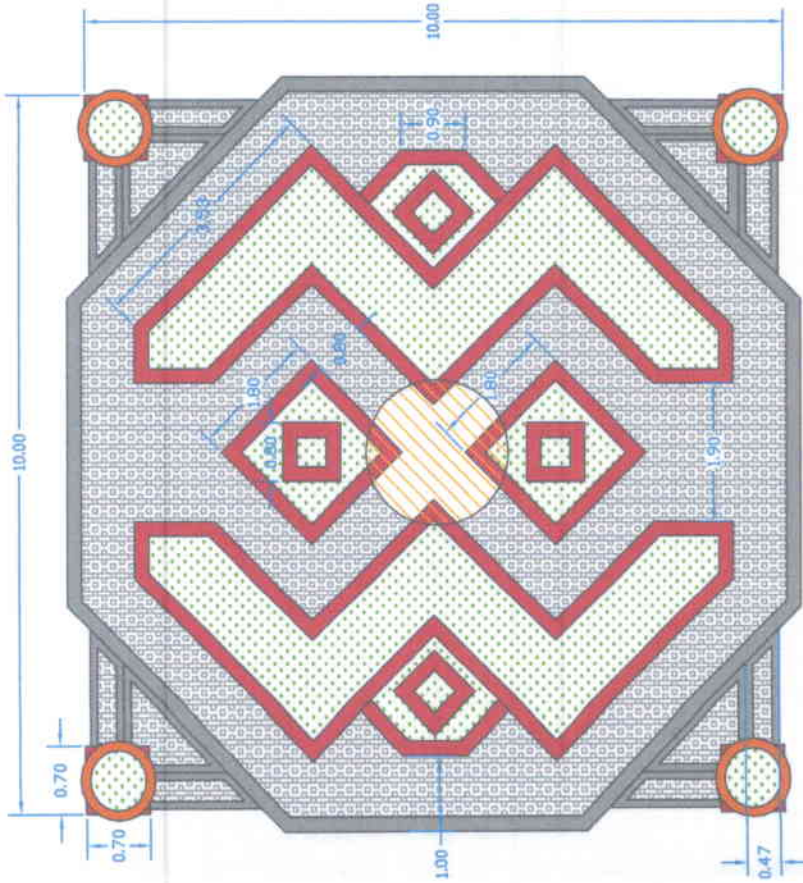

CENTER PLANTBOX #1 (OPTION 1)

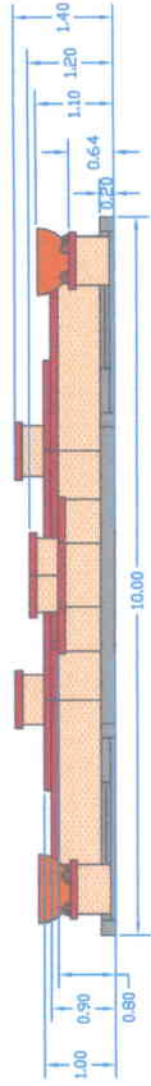
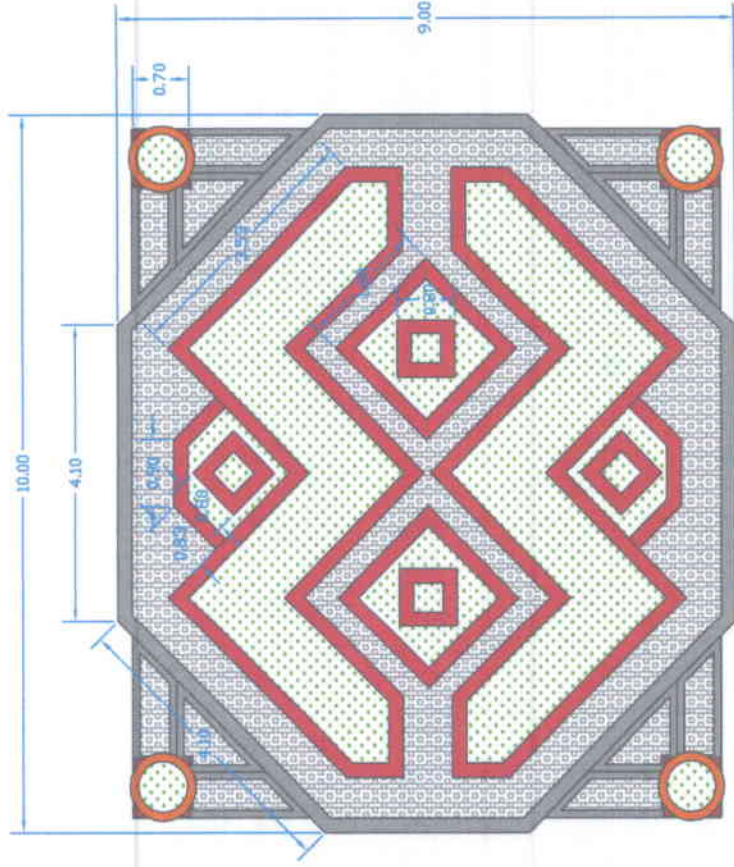

CENTER PLANTBOX #1 (OPTION 2)

**LEGEND:**

-  PLATFORM
-  PLANTING AREA
-  MOULDING
-  STONE
-  KAWA
-  EXISTING POST

# DETAILED DIMENSIONS OF PROPOSED EDSA POCKET PARK FOR THE FIVE (5) PACKAGES

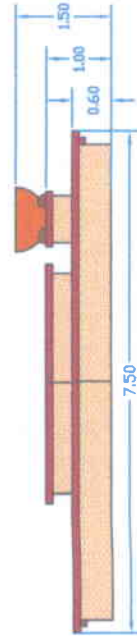
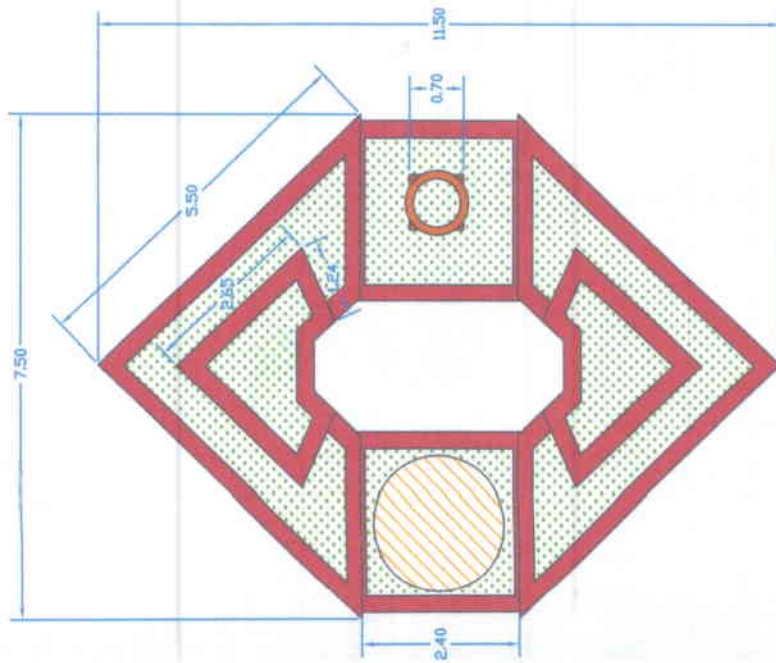

CENTER COLUMN PLANTBOX #1

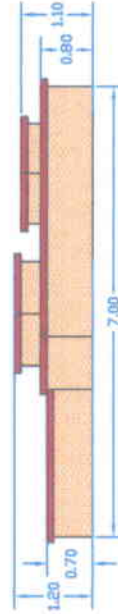
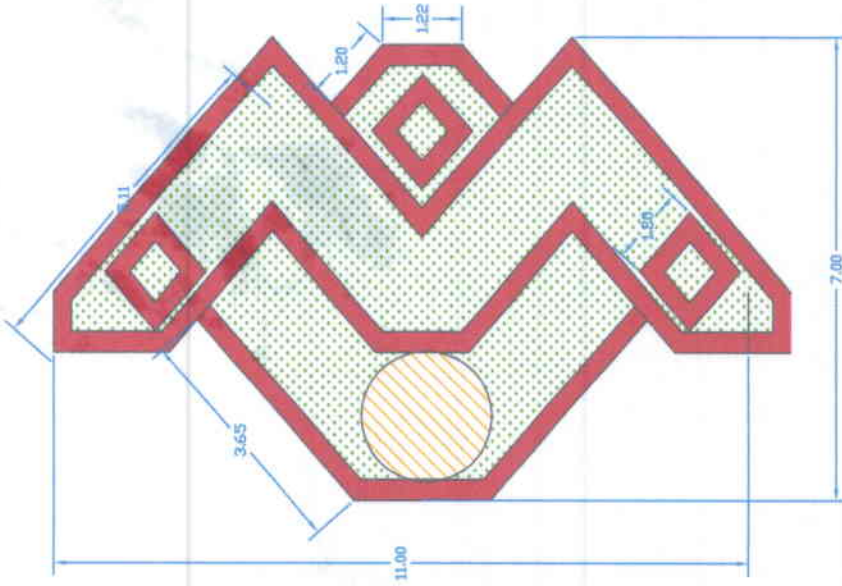

CENTER COLUMN PLANTBOX #2

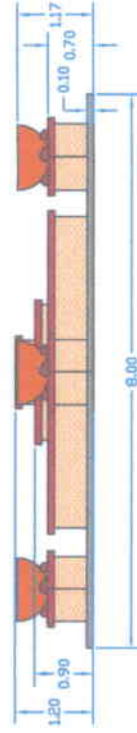
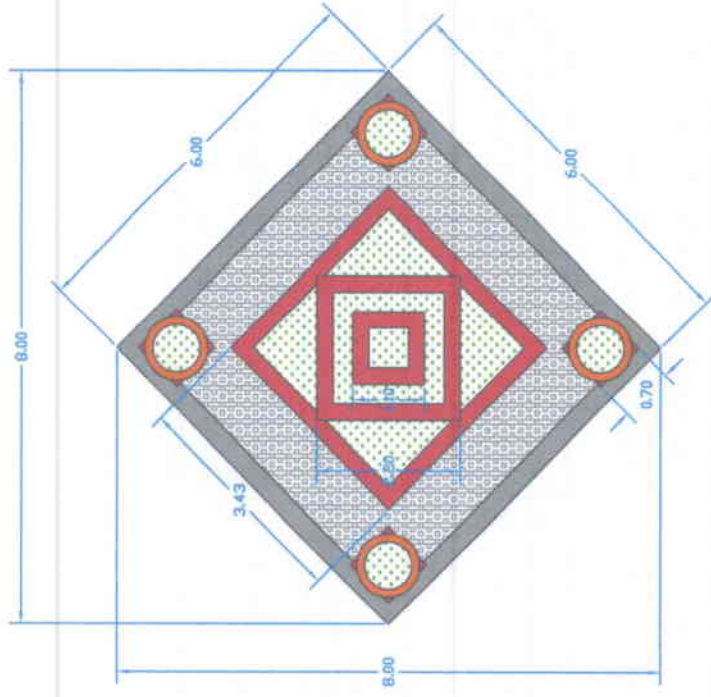

CENTER PLANTBOX #2

LEGEND:

-  PLATFORM
-  PLANTING AREA
-  MOULDING
-  STONE
-  KAWA
-  EXISTING POST